

# EasyTouch Plus Garment Steamer

Service  
Service  
Service  
Service

**GC512**      **GC522**  
**GC513**      **GC523**  
**GC514**      **GC524**  
**GC516**      **GC527**  
**GC517**      **RI514**  
**GC518**      **RI524**

Philips Consumer Lifestyle

Version 1

# Service Manual

## Technical Information

- Voltage : 220 – 240 V (ROW)
  - Taiwan LV : 110 V
  - Brazil HV : 220 – 240 V
  - Brazil LV : 127 V
  - China/Korea HV : 220 V
- Frequency : 50 – 60 Hz
- Power : 1600 W
- Dimensions : 433 x 1620 x 311 mm
- Weight : 3.2 ± 0.1 kg

## Product information

### Fast crease removal

- Continuous steam: 32 g/min
- Power: 1600 W
- Ready to use: <1 min
- Variable steam: 3–5 levels
- Variable steam levels
- Vertical steam

### Easy to use

- Safe on all fabrics: Even delicates like silk
- Water tank capacity: 1600 ml
- Detachable water tank
- Integrated power plug

### Scale management

- Descaling and cleaning: Easy De-calc

### Green efficiency

- Product packaging: 100% recyclable
- User manual: 100% recycled paper

### Safety Information

- This product meets the requirements regarding interference suppression on radio and TV.

### Guarantee

- 2 year worldwide guarantee

## Accessories included

Accessory	Model Number
Glove	All models
Hanger (1 pole) Fuchsia	GC514/46, GC514/40, GC514/49, GC514/48, GC514/48, GC514/48, GC514/40, GC514/40, GC514/46, GC514/40, RI514/42, RI514/44, GC514/40
Hanger (1 pole) Medium Purple	GC514/36
Hanger (1 pole) Modern Pink	GC512/40, GC512/48
Hanger (2 pole) Fuchsia	GC513/48
Hanger (1 pole with pant clips) Petrol Dusk	GC518/26, GC518/20, GC518/29, GC518/28, GC518/20, GC518/23, GC518/20, GC518/20, GC518/20, GC518/20, GC516/28, GC527/20
Hanger (1 pole with pant clips) Chalky Camel	GC524/69, GC524/68, GC524/60, GC524/60, GC524/66, GC524/60, RI524/62, RI524/64, GC524/63, GC524/60, GC524/60, GC522/68
Hanger (2 pole with pant clips) Petrol Dusk	GC517/28
Hanger (2 pole with pant clips) Chalky Camel	GC523/68
Pole (one piece)	All models
Brush P–Dusk	GC518/26, GC518/20, GC518/29, GC518/28, GC518/20, GC518/23, GC518/20, GC518/20, GC518/20, GC517/28, GC516/28
Brush C–Camel	GC524/60, GC524/69, GC524/68, GC524/60, GC524/60, GC524/66, GC524/60, RI524/62, RI524/64, GC524/60, GC524/60, GC524/60, GC522/68
Mat (Single Pole)	GC522/68
Mat (Double Pole)	GC517/28, GC523/68
Boards	GC524, GC527
Board Cover	GC524, GC527

Exploded view

GC514 / GC518 / GC524 / GC527  
RI514 / RI524

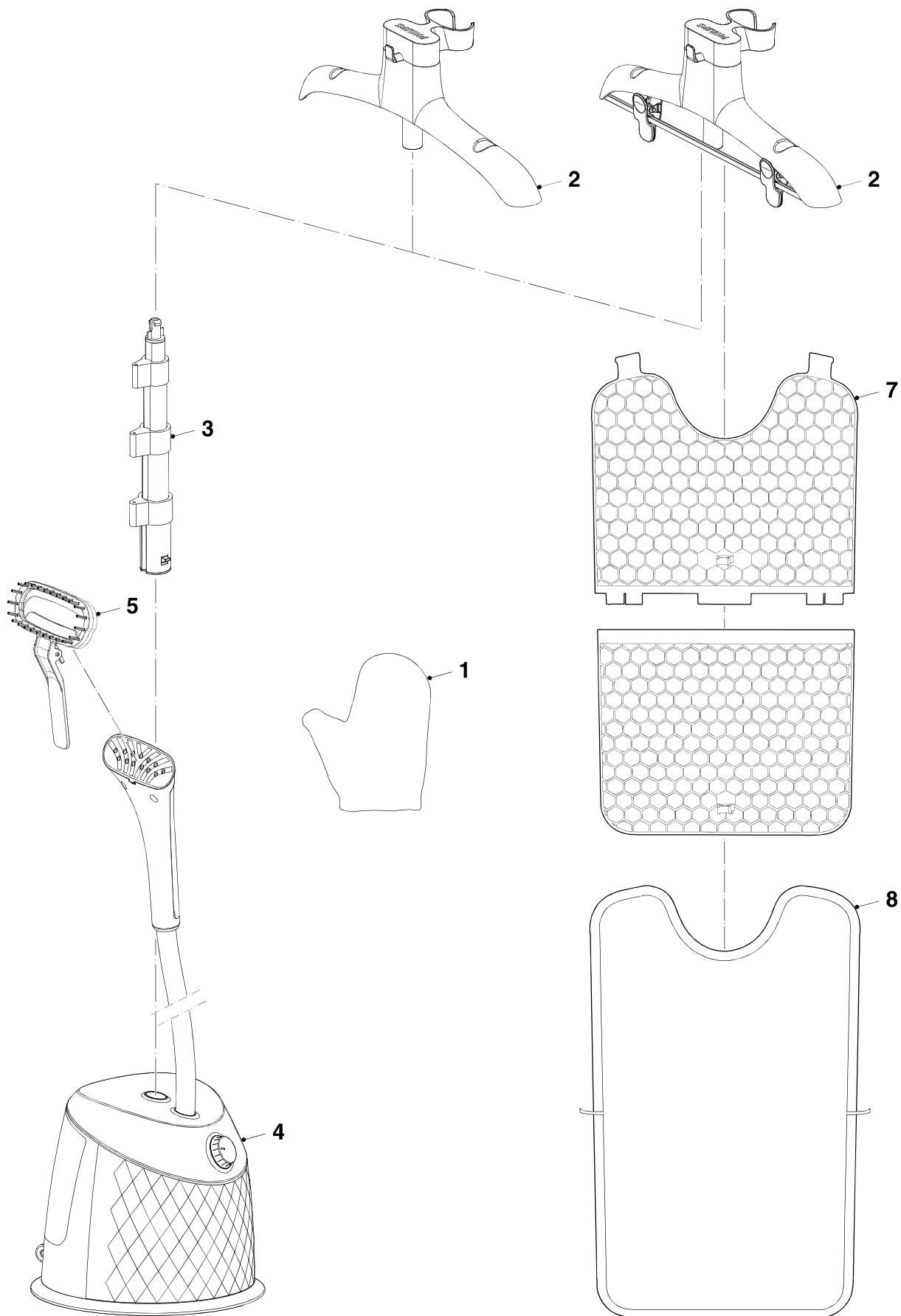

**Dismantle advice:**

- Remove hanger
- Remove pole

**Repair instruction:**

- After the product has been repaired, it should function properly and has to meet the safety requirements.